

brooks

World Class Precision Engineering

CRANK LINK ROTARY DRIVE CHAIN

Rotary or cranked link drive chains were developed for use in applications where large amounts of power need to be transmitted. Heavy duty cranked link drive chains are generally found working under extreme operating conditions due to their strength, wear resistance and ability to absorb shock loads.

Common applications include necklace drives around trommel screens, transmission of power from large motors/gearboxes and as drag chains for large engineered components.

Heavy duty cranked link rotary drive chains are covered by the ISO 3512:1992(E), ASME (ANSI) B29.10(M) and DIN 8182:1999 standards.

MXS Chain No.	API Chain No	ISO Chain no	P mm	L mm	D1 mm	D6 mm	H mm	S mm	F1 mm	F2 mm	F3 mm	BL kN
432			42.0	25.4	22.4	11.1	mm	4.8	57.9	25.9	32.0	89
881			66.3	28.4	22.4	11.1	28.4	4.8	60.5	27.7	32.5	89
882			66.3	28.4	22.4	11.1	28.4	6.4	66.5	31.0	35.8	116
3011		2512	77.9	39.6	41.1	19.1	57.2	9.7	100.1	46.0	53.8	340
1031			78.1	38.1	31.8	15.9	38.1	7.9	85.9	40.4	46.7	214
1032			78.1	38.1	31.8	15.9	41.1	7.9	87.1	40.4	46.7	267
1075			78.1	38.1	31.8	16.5	44.5	9.7	93.7	43.7	50.0	334
	3P		78.1	38.1	31.8	16.5	39.6	9.7	95.8	0.0	0.0	334
3514		814	88.9	38.1	44.5	22.2	57.2	12.7	112.8	52.3	60.5	623
1242			03.2	49.3	44.5	22.2	57.2	12.7	124.0	57.2	66.5	623
	4P		03.2	50.8	44.5	22.2	57.2	12.7	126.0	0.0	0.0	667
4245		315	03.5	49.3	45.2	23.8	60.5	14.2	130.0	60.5	69.9	756
5522		618	14.3	52.3	57.2	27.9	76.2	14.2	133.4	62.0	71.4	980
5031		020	27.0	69.9	63.5	31.8	88.9	15.7	158.8	73.9	84.8	1380
5035			27.0	65.0	63.5	34.9	88.9	19.1	168.1	79.2	88.9	1557
5542			39.7	76.2	76.2	38.1	01.6	19.1	180.8	83.3	97.5	1868
888			46.1	76.2	76.2	38.1	01.6	19.1	180.8	83.3	97.5	1868
6042		824	52.4	76.2	76.2	38.1	01.6	19.1	180.8	83.3	97.5	1868
6565			65.1	88.9	88.9	44.5	27.0	22.4	209.8	98.6	111.3	2670
7065			77.8	82.6	88.9	44.5	27.0	22.4	204.7	96.8	108.0	2670
		628	77.8	82.5	88.9	44.5		22.4	215.9	101.6	114.3	1890

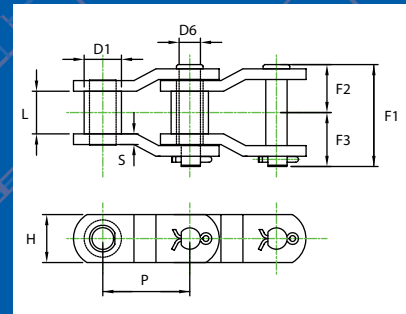

Twitter.com/chain4conveyors
 LinkedIn.com/company/conveyorchain
 Facebook.com/conveyorchain

Telephone +44 (0) 161 666 5000
 Website www.chain.zone
 Email chains@brooks.ltd.uk

Head Office (UK)
 117 Manchester Rd, Manchester M34 5UU, England

Malaysia Office
 Brooks Andell Sdn Bhd, 30/32 PJU 3/49, Sunway Damansara, Petaling Jaya, Selangor, Malaysia, 47810,

USA Office
 Brooks USA Inc, 2993 S. Oak Way, Lakewood, CO 80227, USA,